

WHY CHOOSE THE ORION MODULAR FOOT



FEATURES & BENEFITS

An adjustable support foot made of glass-fiber reinforced polypropylene. The semi-crystalline polymer is characterized by a high breaking load and great thermal resistance. Thanks to the versatility and speed of assembly, the Orion Foot is recommended for the construction of modular structures, piping and wiring support or any combination of the two with standard strut profiles.

- **Adjustable support foot** – with central body, ball joint and four fixing points
- **Prevent flooding and water egress** - Perfect unitary air handler stand
- **Versatility and speed of assembly** decreases install time
- **Superior vibration absorption and surface safe** - with built-in NBR rubber pad
- **Strong** - High breaking load and great thermal resistance, glass-fiber reinforced polypropylene

| Part Number | Dimensions | Capacity |
|------------------|---|----------|
| ORION-550 | Min Height: 7" Max Height: 11" Base diameter: 12" | 550 lbs. |

DIRECT INSTALLATION ON EQUIPMENT FRAME OR WITH CABLE TRAYS & PIPING SUPPORT



SUBMITTAL DATA SHEET | ORION MODULAR FOOT

| | | | |
|-------------------------|--------------------------|--------------------------|--------------------------|
| Job Name | Location | | |
| Purchaser | Engineer | | |
| Submitted To | Reference | Approval | Construction |
| Submitted By | <input type="checkbox"/> | <input type="checkbox"/> | <input type="checkbox"/> |
| Unit Designation | Schedule | | |
| Construction | Date | | |

COMPONENTS

1. Ball Joint for Easy Installation
2. NBR Rubber Pad for Vibration Absorption
3. Adjustable Central Body
4. Built-in NBR Pad for Easy Positioning & Surface Damage Protection
5. Four Fixing Points

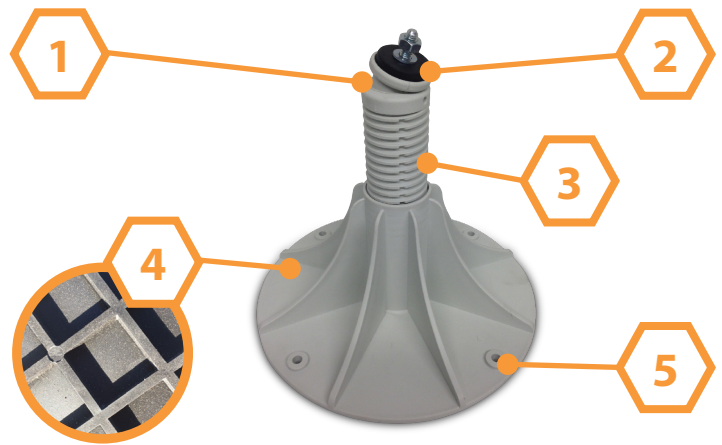

COMBINATION EXAMPLE

FOUR-FOOT MODULAR STRUT STRUCTURE

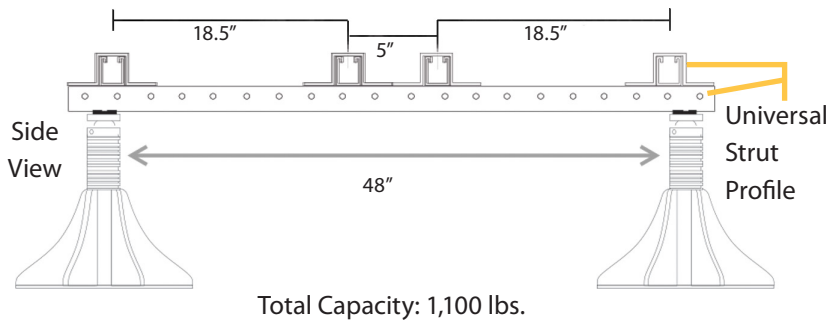

CABLE TRAYS & PIPING SUPPORT

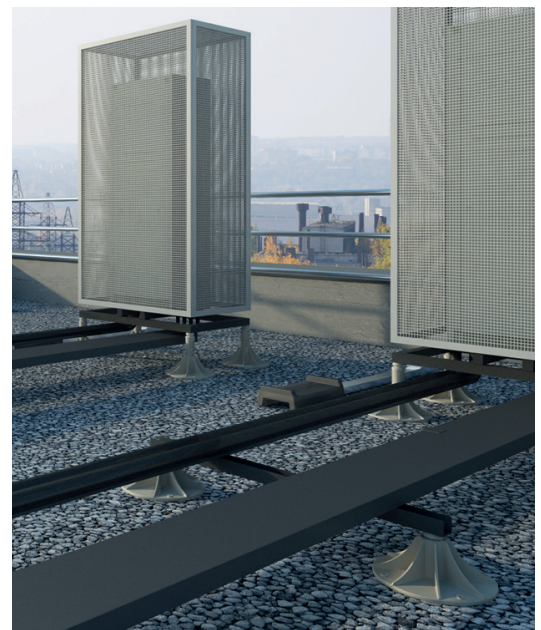

MULTIPLE STRUT COMBINATIONS

